

**VICOR CONFIDENTIAL**

THIS DOCUMENT AND THE DATA DISCLOSED  
HEREIN OR HEREWITH IS NOT TO BE REPRODUCED,  
USED, OR DISCLOSED IN WHOLE OR IN PART  
TO ANYONE WITHOUT PERMISSION OF VICOR CORP.

REV.	DESCRIPTION	DATE	APPROVED
01	RELEASED- E950641	RCH 11/3/95	DPK

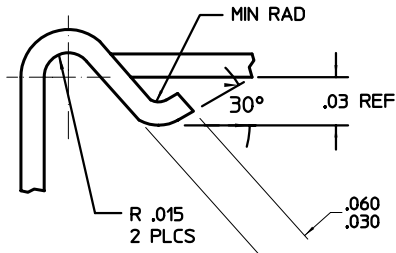

**DETAIL A**

SCALE 8:1  
2 PLACES

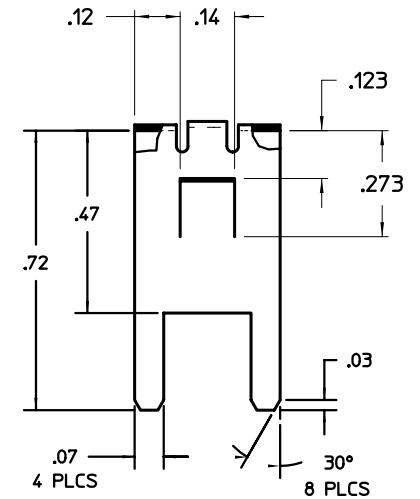
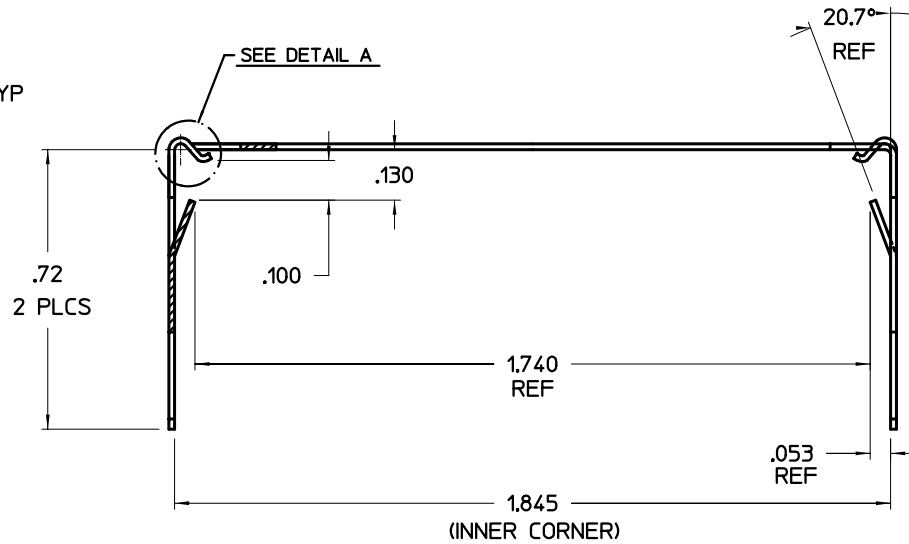
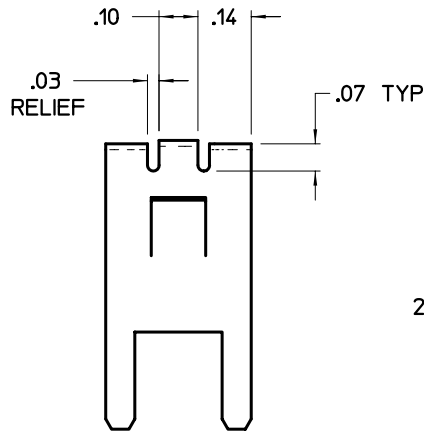
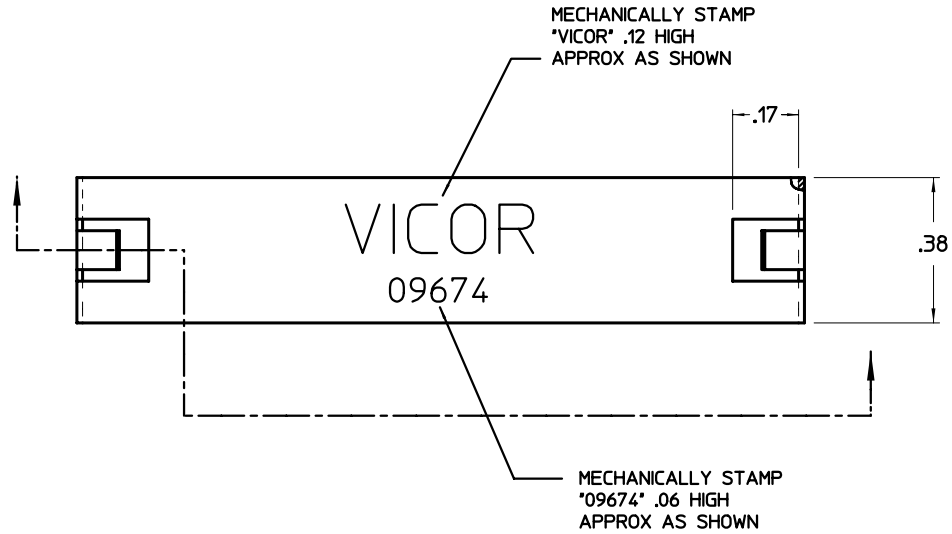

**NOTES:**

1. MATERIAL: .015 THICK 260 1/2 HARD BRASS STOCK.
2. FINISH: COPPER STRIKE & 60/40 TIN-LEAD SOLDER PLATE TO 100-300 MICRO INCH THICK.
3. ALL UNSPECIFIED INSIDE BEND RADII TO BE .015 MAX.

UNLESS OTHERWISE SPECIFIED  
DIMENSIONS ARE IN INCHES  
TOLERANCES ARE:

FRACTIONS	DECIMALS	ANGLES
± 1/64	± .01	± 1°
	± .005	

THIRD ANGLE PROJECTION



DO NOT SCALE DRAWING

APPROVALS	DATE
DRAWN: DRC	10/93

CLIP, FASTENER, SLIM MOD	
SIZE: FSCH NO. <b>C 67131</b>	DWG. NO. 09674
SCALE: 4:1	REV. 01
SHEET 1 OF 1	