

**VICOR CONFIDENTIAL**

THIS DOCUMENT AND THE DATA DISCLOSED HEREIN OR HEREWITH IS NOT TO BE REPRODUCED, USED, OR DISCLOSED IN WHOLE OR IN PART TO ANYONE WITHOUT PERMISSION OF VICOR CORP.

REV.	DESCRIPTION	DATE	APPROVED
1	DRAWN 5/10/93	HHC	
01	REVISED & RELEASED E930638	JFW	

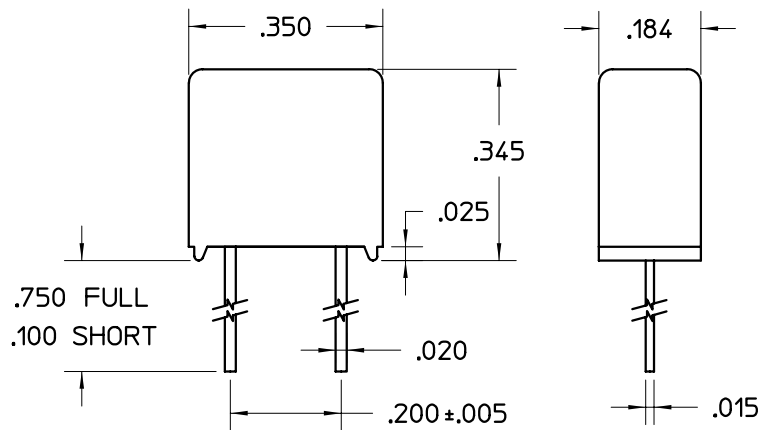

**NOTES:**

- 1.) TIME CURRENT CHARACTERISTICS: CARRY 100% OF RATING FOR 4.0 HRS. MINIMUM, OPEN OF 200% OF RATING IN 10 SECONDS MAXIMUM. (NON-TIME DELAY).
- 2.) AGENCY APPROVALS:  
 PCB, PCC, PCD, PDE, PCF, PCH & PCI. UL RECOGNIZED: FILE E19180. GUIDE JDYX2. (PCC APPROVAL PENDING)  
 CSA CERTIFIED: FILE 42731, CLASS 1421-01.  
 PCG CERTIFICATION PENDING.
- 3.) RATINGS 2.5 AMPS, 250 V.
- 4.) COLD RESISTANCE DATA: (10% RATED CURRENT) NOMINAL VALUE 2.5 A - .10Ω.

MARKING:  
MFG. ID/PF CODE

UNLESS OTHERWISE SPECIFIED DIMENSIONS ARE IN INCHES TOLERANCES ARE:

FRACTIONS	DECIMALS	ANGLES
± 1/64	.XX ± .01	± 1°
	.XXX ± .005	

THIRD ANGLE PROJECTION

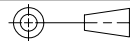

DO NOT SCALE DRAWING

APPROVALS	DATE
DRAWN: H. CLINE	5/10/93
CHECKED:	
ISSUED	
APP'D	

<b>BUSS FUSE, PC-TRON</b> <b>2.5A</b>			
SIZE	FSCM NO.	DWG. NO.	REV.
B	67131	08395	01
SCALE: NONE		SHEET 1 OF 1	